

Double Robe Hook

Model: BS8-22

Features

- Concealed Surface Mount Application
- Provided with
 - Mounting Plate: 2-1/4" x 1"
 - Plastic Anchors x 2
 - Steel Phillips Head Screws #8 x 1-1/4"
- Projection: 2-3/8" from Mounting Surface
- Overall Size: 3" x 3"

La Quinta
Collection



Available Finish

- | | |
|-----------------------------------------|-----------------------------------------|
| <input type="checkbox"/> Chrome | <input type="checkbox"/> Satin Nickel |
| <input type="checkbox"/> Polished Brass | <input type="checkbox"/> Nickel / Brass |
| <input type="checkbox"/> Chrome / Brass | |

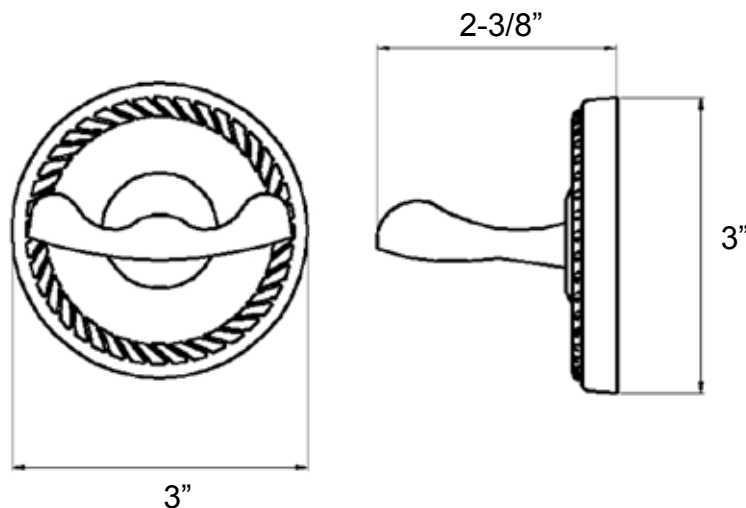

Metal Towel Ring

Model: BS8-30

Features

- Concealed Surface Mount Application
- Provided with
 - Mounting Plate: 2-1/4" x 1"
 - Plastic Anchors x 2
 - Steel Phillips Head Screws #8 x 1-1/4"
- Projection: 1-5/8" from Mounting Surface
- Overall Size: 6-1/2" x 7-1/2"
- Ring: 6-1/2" Diameter

La Quinta
Collection



Available Finish

- | | |
|-----------------------------------------|-----------------------------------------|
| <input type="checkbox"/> Chrome | <input type="checkbox"/> Satin Nickel |
| <input type="checkbox"/> Polished Brass | <input type="checkbox"/> Nickel / Brass |
| <input type="checkbox"/> Chrome / Brass | |

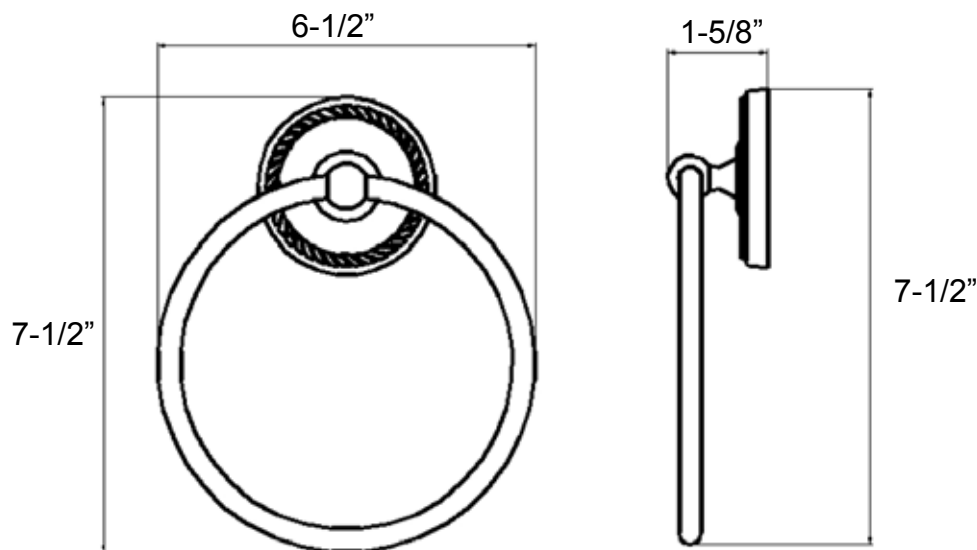

Surface Paper Holder

Model: BS8-42

Features

- Material: Zinc Die-cast
- Concealed Surface Mount Application
- Provided with
 - Mounting Plate: 2-1/4" x 1"
 - Plastic Anchors x 4
 - Steel Phillips Head Screws #8 x 1-1/4"
- Projection: 2-15/16" from Mounting Surface
- Spring Load Plastic Paper Holder Roller
7/8" Diameter x 6"
- Overall Size: 3" x 9"

La Quinta
Collection



Available Finish

- | | |
|-----------------------------------------|-----------------------------------------|
| <input type="checkbox"/> Chrome | <input type="checkbox"/> Satin Nickel |
| <input type="checkbox"/> Polished Brass | <input type="checkbox"/> Nickel / Brass |
| <input type="checkbox"/> Chrome / Brass | |

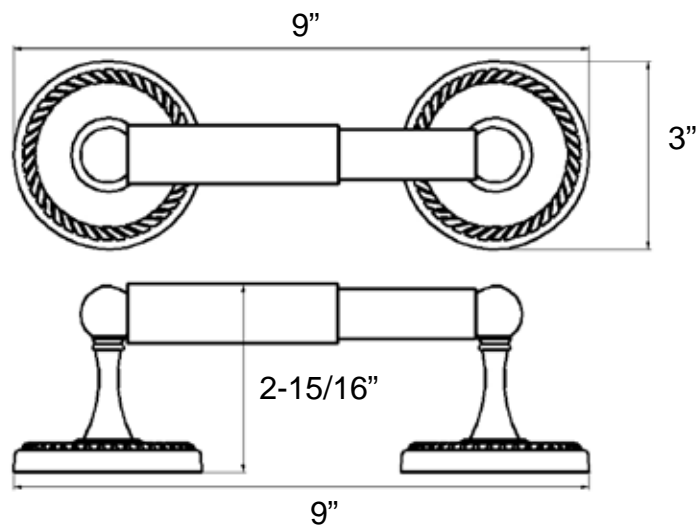

European-Style Paper Holder

Model: BS8-43

Features

- Material: Zinc Die-cast
- Concealed Surface Mount Application
- Provided with
 - Mounting Plate: 2-1/4" x 1"
 - Plastic Anchors x 2
 - Steel Phillips Head Screws #8 x 1-1/4"
- Projection: 2-7/16" from Mounting Surface
- Overall Size: 6" x 4-3/8"

La Quinta
Collection



Available Finish

- | | |
|-----------------------------------------|-----------------------------------------|
| <input type="checkbox"/> Chrome | <input type="checkbox"/> Satin Nickel |
| <input type="checkbox"/> Polished Brass | <input type="checkbox"/> Nickel / Brass |
| <input type="checkbox"/> Chrome / Brass | |

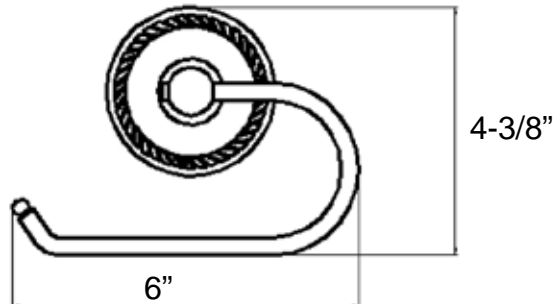
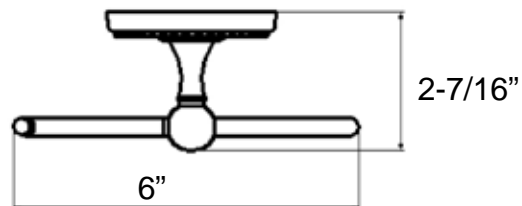

Tooth Brush & Glass Tumbler Holder

Model: BS8-50

Features

- Concealed Surface Mount Application
- Provided with
 - Mounting Plate: 2-1/4" x 1"
 - Plastic Anchors x 2
 - Steel Phillips Head Screws #8 x 1-1/4"
- Projection: 4-1/4" from Mounting Surface
- Overall Size: 3" x 4-1/8"

La Quinta
Collection



Available Finish

- | | |
|-----------------------------------------|-----------------------------------------|
| <input type="checkbox"/> Chrome | <input type="checkbox"/> Satin Nickel |
| <input type="checkbox"/> Polished Brass | <input type="checkbox"/> Nickel / Brass |
| <input type="checkbox"/> Chrome / Brass | |

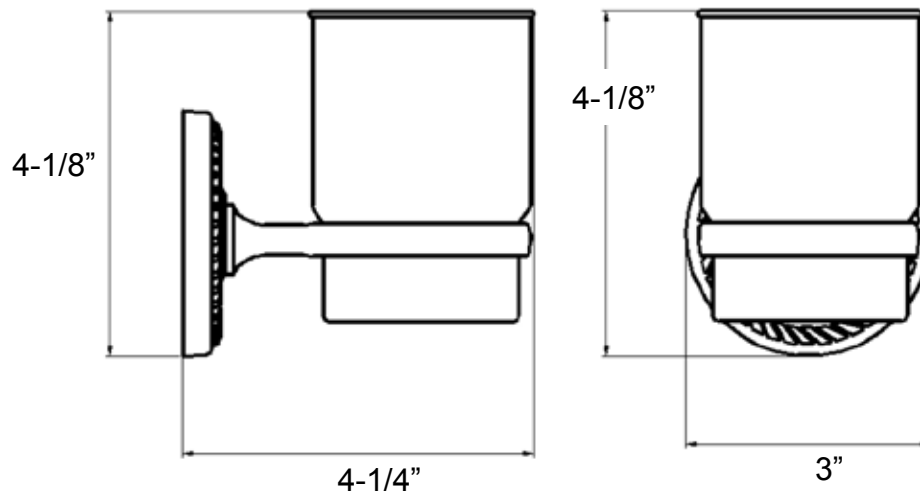

Soap Holder with Glass Dish

Model: BS8-60

Features

- Concealed Surface Mount Application
- Provided with
 - Mounting Plate: 2-1/4" x 1"
 - Plastic Anchors x 2
 - Steel Phillips Head Screws #8 x 1-1/2"
- Projection: 5" from Mounting Surface 4"
- Overall Size: 4-1/4" x 3"

La Quinta
Collection



Available Finish

- | | |
|-----------------------------------------|-----------------------------------------|
| <input type="checkbox"/> Chrome | <input type="checkbox"/> Satin Nickel |
| <input type="checkbox"/> Polished Brass | <input type="checkbox"/> Nickel / Brass |
| <input type="checkbox"/> Chrome / Brass | |

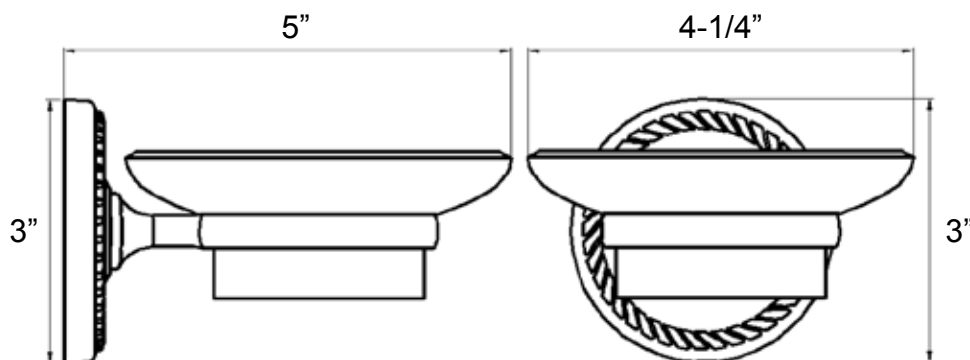

18" x 5/8" Towel Bar (round bar)

Model: BS8-15818

Features

- Concealed Surface Mount Application
- Provided with
 - Mounting Plate: 2-1/4" x 1"
 - Plastic Anchors x 4
 - Steel Phillips Head Screws #8 x 1-1/4"
- Projection: 2-15/16" from Mounting Surface
- Overall Size: 21-1/4" x 3"

La Quinta
Collection



Available Finish

- | | |
|-----------------------------------------|-----------------------------------------|
| <input type="checkbox"/> Chrome | <input type="checkbox"/> Satin Nickel |
| <input type="checkbox"/> Polished Brass | <input type="checkbox"/> Nickel / Brass |
| <input type="checkbox"/> Chrome / Brass | |

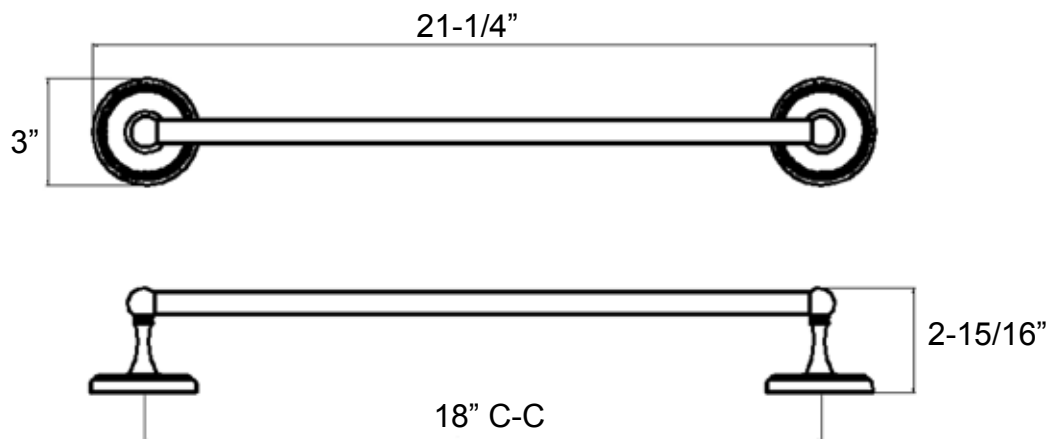

24" x 5/8" Towel Bar (round bar)

Model: BS8-15824

Features

- Concealed Surface Mount Application
- Provided with
 - Mounting Plate: 2-1/4" x 1"
 - Plastic Anchors x 4
 - Steel Phillips Head Screws #8 x 1-1/4"
- Projection: 2-15/16" from Mounting Surface
- Overall Size: 27-1/4" x 3"

La Quinta
Collection



Available Finish

- | | |
|-----------------------------------------|-----------------------------------------|
| <input type="checkbox"/> Chrome | <input type="checkbox"/> Satin Nickel |
| <input type="checkbox"/> Polished Brass | <input type="checkbox"/> Nickel / Brass |
| <input type="checkbox"/> Chrome / Brass | |

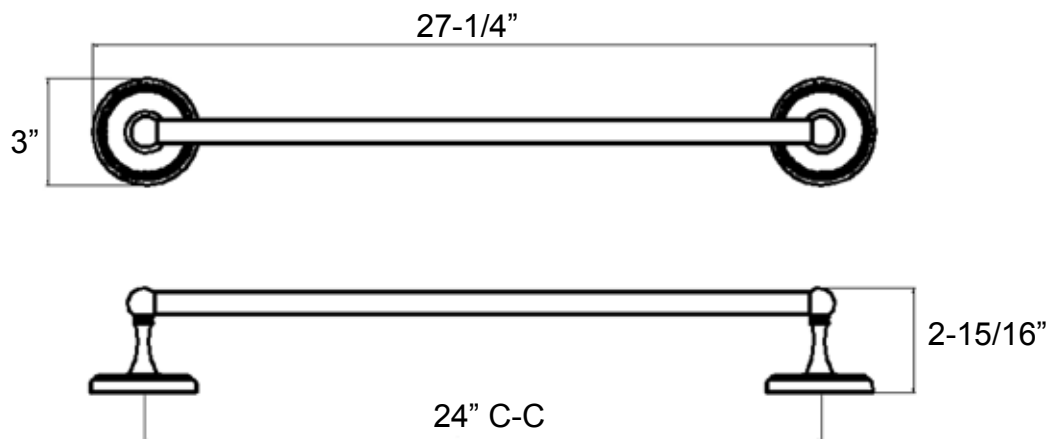

24" x 5/8" Dual Towel Bar (round bar)

Model: BS8-15824D

Features

- Concealed Surface Mount Application
- Provided with
 - Mounting Plate: 2-1/4" x 1"
 - Plastic Anchors x 4
 - Steel Phillips Head Screws #8 x 1-1/4"
- Projection: 5-5/8" from Mounting Surface
- Overall Size: 27-1/2" x 3-1/16"

La Quinta
Collection

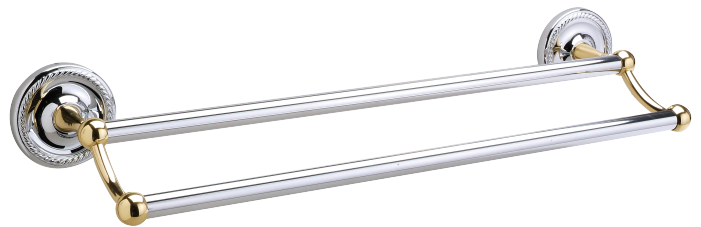

Available Finish

- | | |
|-----------------------------------------|-----------------------------------------|
| <input type="checkbox"/> Chrome | <input type="checkbox"/> Satin Nickel |
| <input type="checkbox"/> Polished Brass | <input type="checkbox"/> Nickel / Brass |
| <input type="checkbox"/> Chrome / Brass | |

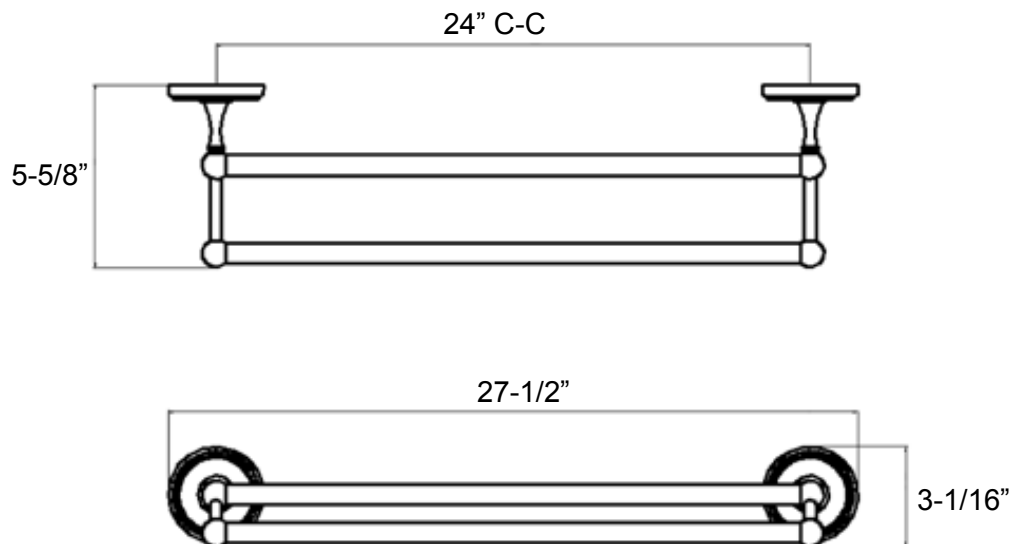

30" x 5/8" Towel Bar (round bar)

Model: BS8-15830

Features

- Concealed Surface Mount Application
- Provided with
 - Mounting Plate: 2-1/4" x 1"
 - Plastic Anchors x 4
 - Steel Phillips Head Screws #8 x 1-1/4"
- Projection: 2-15/16" from Mounting Surface
- Overall Size: 33-1/4" x 3"

La Quinta
Collection



Available Finish

- | | |
|-----------------------------------------|-----------------------------------------|
| <input type="checkbox"/> Chrome | <input type="checkbox"/> Satin Nickel |
| <input type="checkbox"/> Polished Brass | <input type="checkbox"/> Nickel / Brass |
| <input type="checkbox"/> Chrome / Brass | |

