

Towel Bar Post (3/4" round)

Model: BC7-13800

Features

- Material: Zinc Die-cast
- Concealed Surface Mount Application
- Provided with
 - Mounting Plate: 2-3/16" x 1"
 - Plastic Anchors x 4
 - Steel Phillips Head Screws #8 x 1-1/4"
- Projection: 3-5/8" from Mounting Surface
- Overall Size: 2-3/4" x 2-3/4"

Ventura
Collection

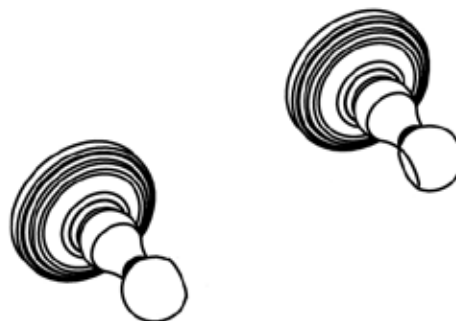

Available Finish

- | | | |
|---|--|--------------------------------------|
| <input type="checkbox"/> Chrome | <input type="checkbox"/> Antique Nickel | <input type="checkbox"/> Matte Black |
| <input type="checkbox"/> Polished Brass | <input type="checkbox"/> Nickel / Brass | <input type="checkbox"/> Dark Bronze |
| <input type="checkbox"/> Chrome / Brass | <input type="checkbox"/> Oil Rubbed Bronze | |
| <input type="checkbox"/> Satin Nickel | <input type="checkbox"/> Venetian Bronze | |

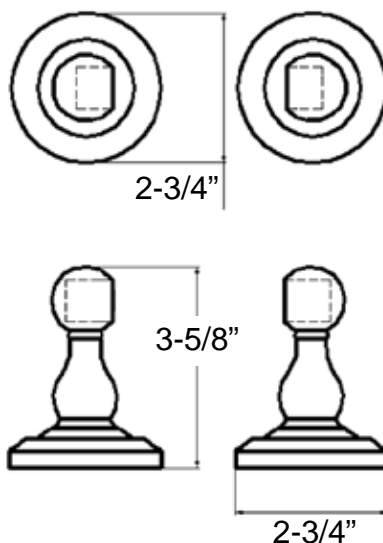

18" x 3/4" Towel Bar (round Bar)

Model: BC7-13818

Ventura
Collection

Features

- Material: Zinc Die-cast
- Concealed Surface Mount Application
- Provided with
 - Mounting Plate: 2-3/16" x 1"
 - Plastic Anchors x 4
 - Steel Phillips Head Screws #8 x 1-1/4"
- Projection: 3-5/8" from Mounting Surface
- Overall Size: 21" x 2-3/4"



Available Finish

- | | | |
|---|--|--------------------------------------|
| <input type="checkbox"/> Chrome | <input type="checkbox"/> Antique Nickel | <input type="checkbox"/> Matte Black |
| <input type="checkbox"/> Polished Brass | <input type="checkbox"/> Nickel / Brass | <input type="checkbox"/> Dark Bronze |
| <input type="checkbox"/> Chrome / Brass | <input type="checkbox"/> Oil Rubbed Bronze | |
| <input type="checkbox"/> Satin Nickel | <input type="checkbox"/> Venetian Bronze | |

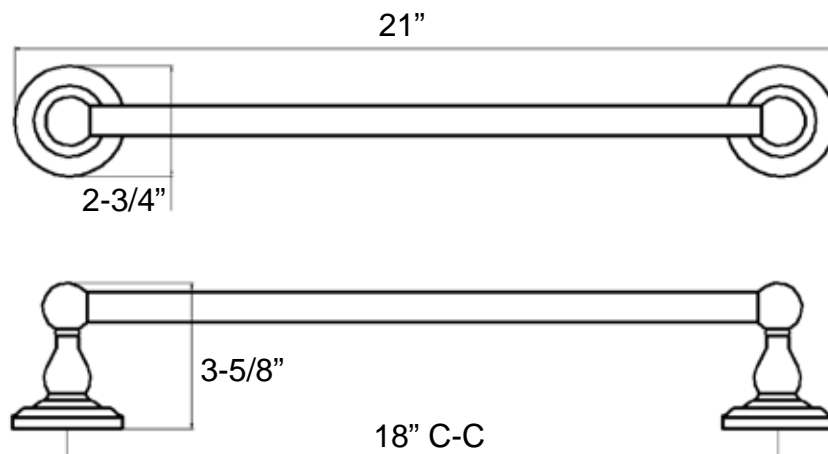

24" x 3/4" Towel Bar (round Bar)

Model: BC7-13824

Ventura
Collection

Features

- Material: Zinc Die-cast
- Concealed Surface Mount Application
- Provided with
 - Mounting Plate: 2-3/16" x 1"
 - Plastic Anchors x 4
 - Steel Phillips Head Screws #8 x 1-1/4"
- Projection: 3-5/8" from Mounting Surface
- Overall Size: 24" x 2-3/4"



Available Finish

- | | | |
|---|--|--------------------------------------|
| <input type="checkbox"/> Chrome | <input type="checkbox"/> Antique Nickel | <input type="checkbox"/> Matte Black |
| <input type="checkbox"/> Polished Brass | <input type="checkbox"/> Nickel / Brass | <input type="checkbox"/> Dark Bronze |
| <input type="checkbox"/> Chrome / Brass | <input type="checkbox"/> Oil Rubbed Bronze | |
| <input type="checkbox"/> Satin Nickel | <input type="checkbox"/> Venetian Bronze | |

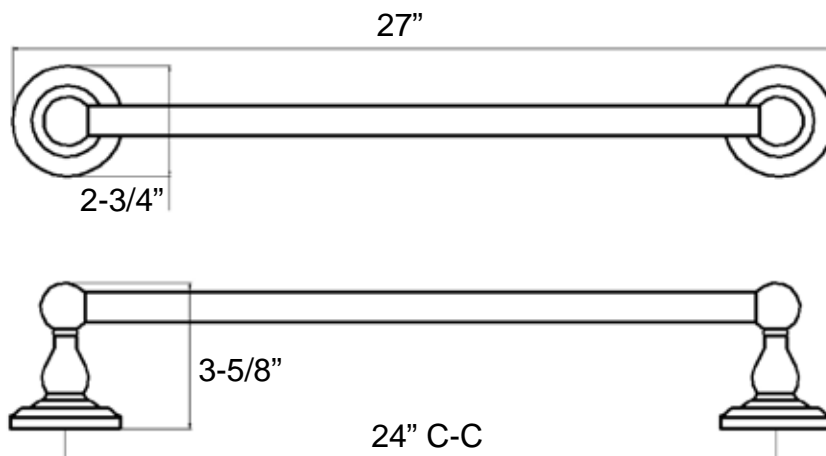

30" x 3/4" Towel Bar (round Bar)

Model: BC7-13830

Features

- Material: Zinc Die-cast
- Concealed Surface Mount Application
- Provided with
 - Mounting Plate: 2-3/16" x 1"
 - Plastic Anchors x 4
 - Steel Phillips Head Screws #8 x 1-1/4"
- Projection: 3-5/8" from Mounting Surface
- Overall Size: 33" x 2-3/4"

Ventura
Collection



Available Finish

- | | | |
|---|--|--------------------------------------|
| <input type="checkbox"/> Chrome | <input type="checkbox"/> Antique Nickel | <input type="checkbox"/> Matte Black |
| <input type="checkbox"/> Polished Brass | <input type="checkbox"/> Nickel / Brass | <input type="checkbox"/> Dark Bronze |
| <input type="checkbox"/> Chrome / Brass | <input type="checkbox"/> Oil Rubbed Bronze | |
| <input type="checkbox"/> Satin Nickel | <input type="checkbox"/> Venetian Bronze | |

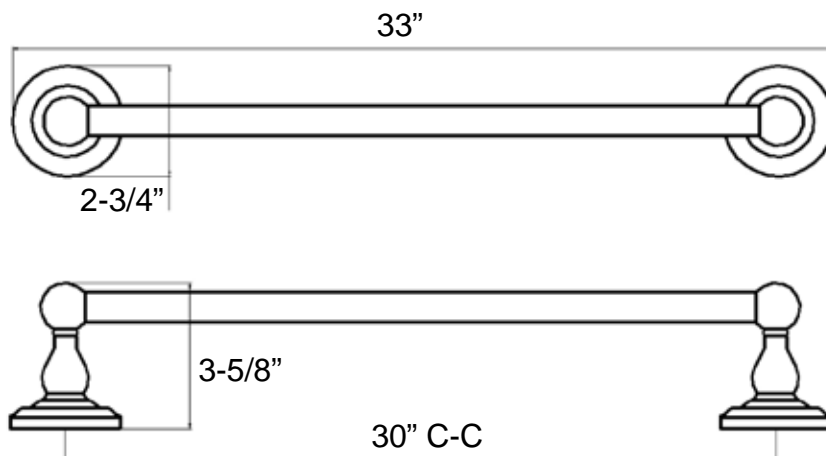

24" x 5/8" Double Towel Bar (round Bar)

Model: BC7-15824D

Features

- Material: Zinc Die-cast
- Concealed Surface Mount Application
- Provided with
 - Mounting Plate: 2-3/16" x 1"
 - Plastic Anchors x 4
 - Steel Phillips Head Screws #8 x 1-1/4"
- Projection: 5" from Mounting Surface
- Overall Size: 27" x 2-15/16"

Ventura
Collection



Available Finish

- | | |
|---------------------------------------|--|
| <input type="checkbox"/> Chrome | <input type="checkbox"/> Dark Bronze |
| <input type="checkbox"/> Matte Black | <input type="checkbox"/> Venetian Bronze |
| <input type="checkbox"/> Dark Bronze | |
| <input type="checkbox"/> Satin Nickel | |

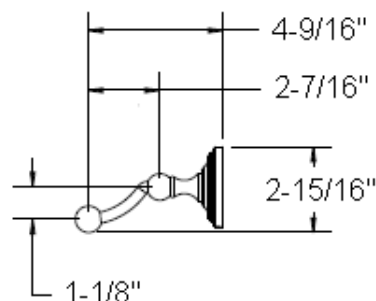
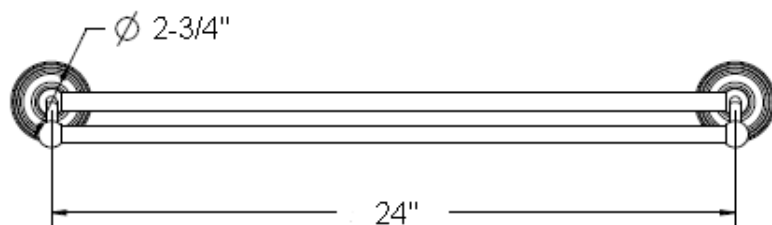
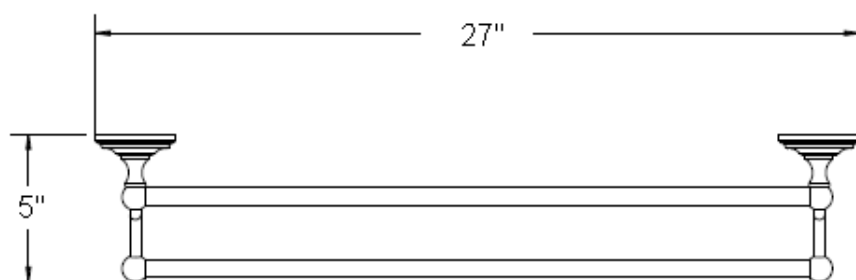

Double Robe Hook

Model: BC7-22

Features

- Material: Zinc Die-cast
- Concealed Surface Mount Application
- Provided with
 - Mounting Plate: 2-3/16" x 1"
 - Plastic Anchors x 2
 - Steel Phillips Head Screws #8 x 1-1/4"
- Projection: 2-1/2" from Mounting Surface
- Overall Size: 2-3/4" x 4-1/4"

Ventura
Collection



Available Finish

- | | | |
|---|--|--------------------------------------|
| <input type="checkbox"/> Chrome | <input type="checkbox"/> Antique Nickel | <input type="checkbox"/> Matte Black |
| <input type="checkbox"/> Polished Brass | <input type="checkbox"/> Nickel / Brass | <input type="checkbox"/> Dark Bronze |
| <input type="checkbox"/> Chrome / Brass | <input type="checkbox"/> Oil Rubbed Bronze | |
| <input type="checkbox"/> Satin Nickel | <input type="checkbox"/> Venetian Bronze | |

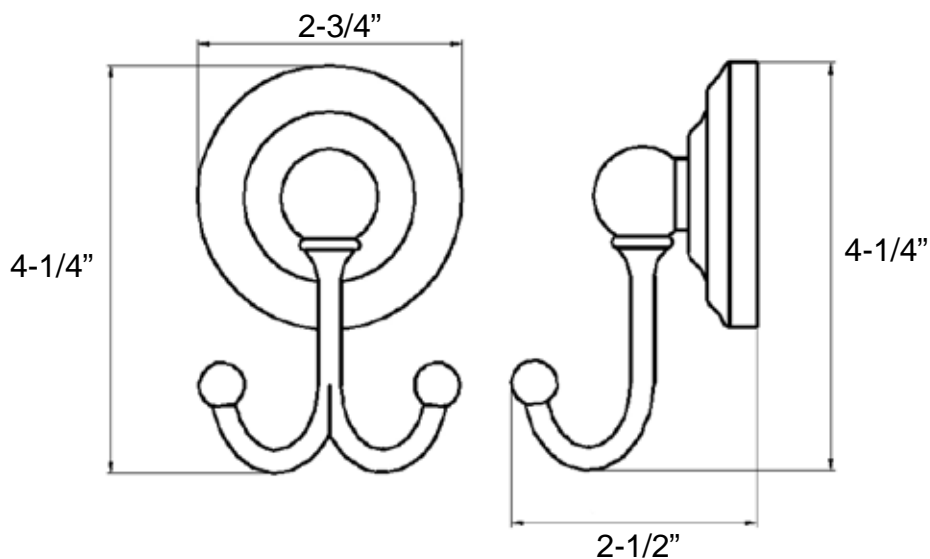

Metal Towel Ring

Model: BC7-30

Features

- Material: Zinc Die-cast
- Concealed Surface Mount Application
- Provided with
 - Mounting Plate: 2-3/16" x 1"
 - Plastic Anchors x 2
 - Steel Phillips Head Screws #8 x 1-1/4"
- Projection: 2-7/8" from Mounting Surface
- Overall Size: 6-1/2" x 7-3/4"

Ventura
Collection



Available Finish

- | | | |
|---|--|--------------------------------------|
| <input type="checkbox"/> Chrome | <input type="checkbox"/> Antique Nickel | <input type="checkbox"/> Matte Black |
| <input type="checkbox"/> Polished Brass | <input type="checkbox"/> Nickel / Brass | <input type="checkbox"/> Dark Bronze |
| <input type="checkbox"/> Chrome / Brass | <input type="checkbox"/> Oil Rubbed Bronze | |
| <input type="checkbox"/> Satin Nickel | <input type="checkbox"/> Venetian Bronze | |

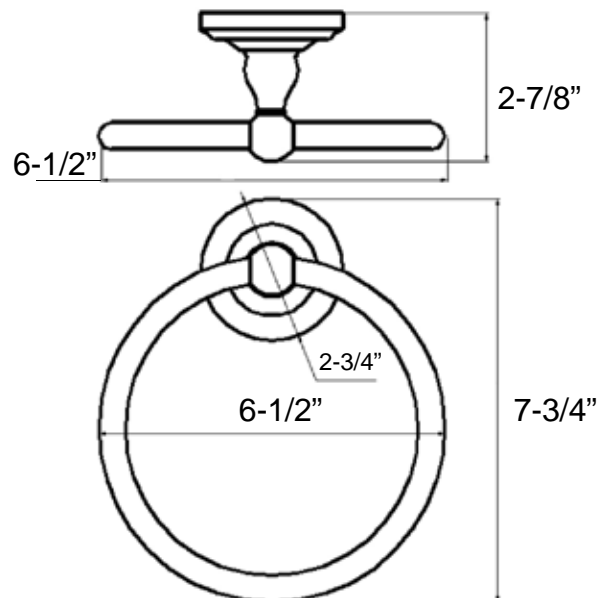

Surface Paper Holder

Model: BC7-42

Features

- Material: Zinc Die-cast
- Concealed Surface Mount Application
- Provided with
 - Mounting Plate: 2-3/16" x 1"
 - Plastic Anchors x 4
 - Steel Phillips Head Screws #8 x 1-1/4"
- Projection: 3-5/8" from Mounting Surface
- Spring-Loaded Plastic Paper Holder Roller 7/8" Diameter x 6"
- Overall Size: 9-1/4" x 2-3/4"

Ventura
Collection



Available Finish

- | | | |
|---|--|--------------------------------------|
| <input type="checkbox"/> Chrome | <input type="checkbox"/> Antique Nickel | <input type="checkbox"/> Matte Black |
| <input type="checkbox"/> Polished Brass | <input type="checkbox"/> Nickel / Brass | <input type="checkbox"/> Dark Bronze |
| <input type="checkbox"/> Chrome / Brass | <input type="checkbox"/> Oil Rubbed Bronze | |
| <input type="checkbox"/> Satin Nickel | <input type="checkbox"/> Venetian Bronze | |

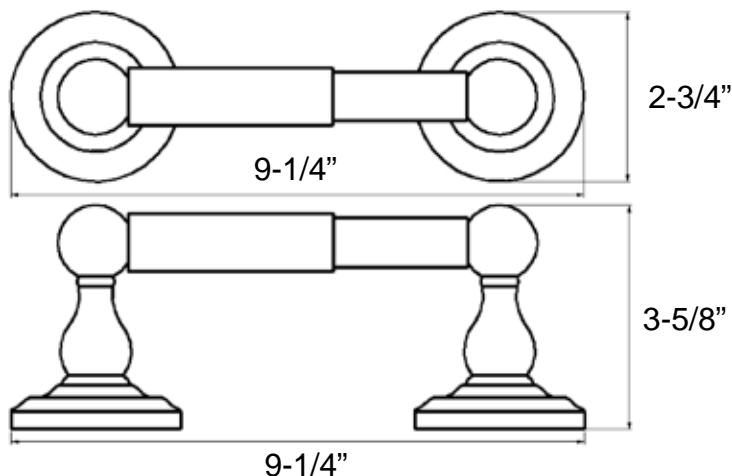

European-Style Paper Holder

Model: BC7-43

Features

- Material: Zinc Die-cast
- Concealed Surface Mount Application
- Provided with
 - Mounting Plate: 2-3/16" x 1"
 - Plastic Anchors x 2
 - Steel Phillips Head Screws #8 x 1-1/4"
- Projection: 2-7/8" from Mounting Surface
- Overall Size: 6" x 4-1/4"

Ventura
Collection



Available Finish

- | | | |
|---|--|--------------------------------------|
| <input type="checkbox"/> Chrome | <input type="checkbox"/> Antique Nickel | <input type="checkbox"/> Matte Black |
| <input type="checkbox"/> Polished Brass | <input type="checkbox"/> Nickel / Brass | <input type="checkbox"/> Dark Bronze |
| <input type="checkbox"/> Chrome / Brass | <input type="checkbox"/> Oil Rubbed Bronze | |
| <input type="checkbox"/> Satin Nickel | <input type="checkbox"/> Venetian Bronze | |

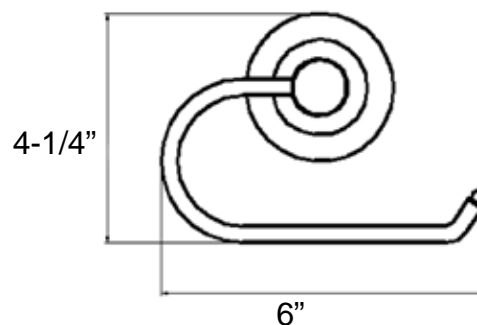
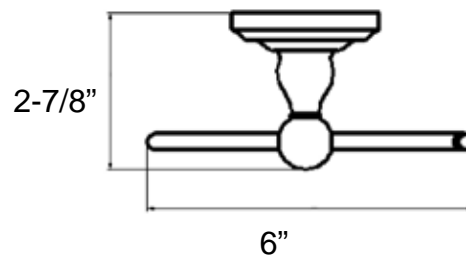

Tooth Brush & Acrylic Tumbler Holder

Model: BC7-50

*Ventura
Collection*

Features

- Material: Zinc Die-cast
- Concealed Surface Mount Application
- Provided with
 - Mounting Plate: 2-3/16" x 1"
 - Plastic Anchors x 2
 - Steel Phillips Head Screws #8 x 1-1/4"
- Projection: 4-7/8" from Mounting Surface
- Overall Size: 5-1/8" x 2-3/4"



Available Finish

- | | |
|---|--|
| <input type="checkbox"/> Chrome | <input type="checkbox"/> Nickel / Brass |
| <input type="checkbox"/> Polished Brass | <input type="checkbox"/> Oil Rubbed Bronze |
| <input type="checkbox"/> Chrome / Brass | <input type="checkbox"/> Dark Bronze |
| <input type="checkbox"/> Satin Nickel | |

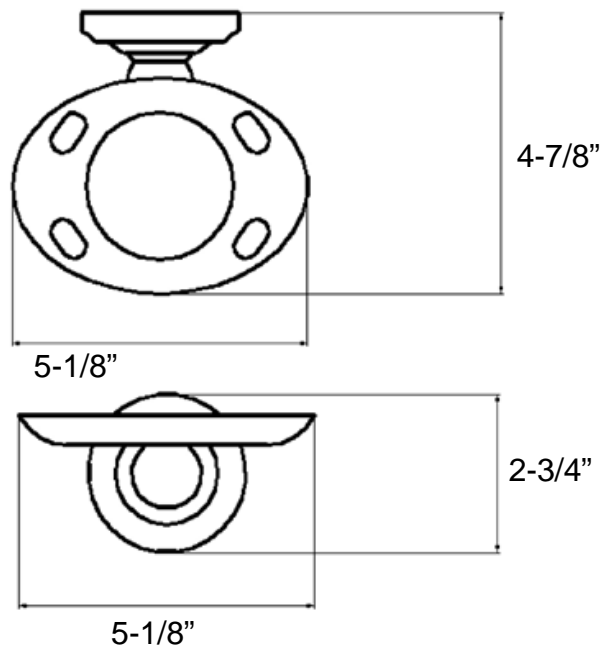

Soap Holder with Acrylic Dish

Model: BC7-60

Features

- Material: Zinc Die-cast
- Concealed Surface Mount Application
- Provided with
 - Mounting Plate: 2-3/16" x 1"
 - Plastic Anchors x 2
 - Steel Phillips Head Screws #8 x 1-1/4"
- Projection: 4-7/8" from Mounting Surface
- Overall Size: 5-1/8" x 2-3/4"

Ventura
Collection



Available Finish

- | | |
|---|--|
| <input type="checkbox"/> Chrome | <input type="checkbox"/> Nickel / Brass |
| <input type="checkbox"/> Polished Brass | <input type="checkbox"/> Oil Rubbed Bronze |
| <input type="checkbox"/> Chrome / Brass | <input type="checkbox"/> Dark Bronze |
| <input type="checkbox"/> Satin Nickel | |

